

Bohrlehre
Installation jig

HEWI

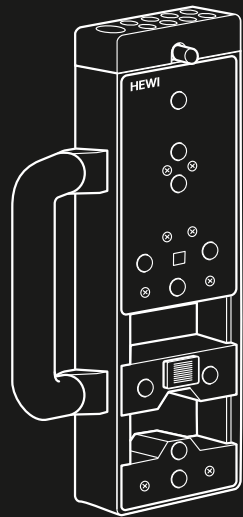

- Ⓓ Bedienungsanleitung
- ⒼⒷ Installation instructions

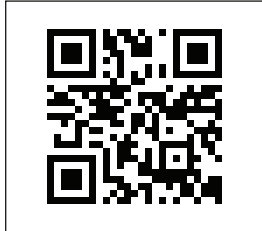

Videoanleitung | Video tutorial
www.hewi.com/bohrlehre

- | | | |
|---|------------------|---|
| Ⓛ | HEWI Support | 0049 5691 82-300 (D),
00 800 4394 4394 (A, CH Freecall Festnetz) |
| Ⓤ | HEWI support | 0044 1634 258200 (UK),
0049 5691 82-0 (International) |
| Ⓧ | Support HEWI | 0033 472 83 09 09 (F),
00 800 4394 4394 (BE, LU, CH appel gratuit, poste fixe) |
| Ⓝ | HEWI support | 00 800 4394 4394 (BE, LU, NL gratis, vaste lijn) |
| Ⓜ | HEWI supportotel | 0049 5691 82 0 |
| ⓔ | HEWI soporte | 0049 5691 82 0 |
| Ⓟ | HEWI wsparcie | 0048 022 330 0052 |

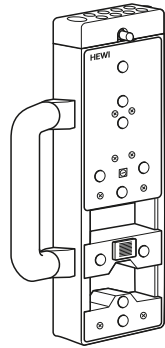



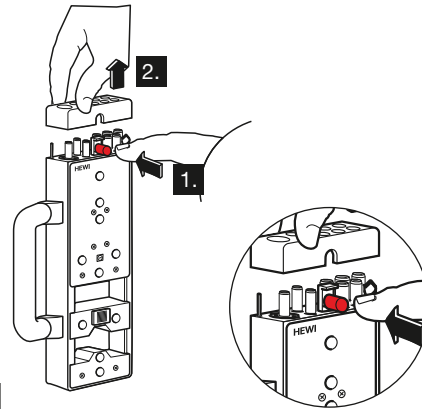



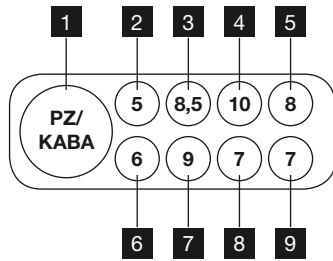
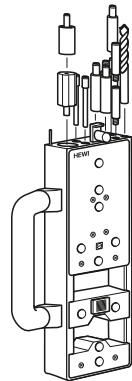



Bohrlehre
Installation jig



1



-  **1** \varnothing 22 mm KABA (Schweiz | Switzerland)
-  **1** \varnothing 17 mm Profilzylinder (PZ) | Euro cylinder
-  **2** \varnothing 5 mm Zentrierdorn | Centering pin
-  **3** \varnothing 8,5 mm Zentrierdorn | Centering pin (Österreich | Austria)
-  **4** \varnothing 10 mm Zentrierdorn | Centering pin
-  **5** \varnothing 8 mm Zentrierdorn | Centering pin
-  **5** \varnothing 8 mm Zentrierdorn | Centering pin
-  **6** \varnothing 6 mm Zentrierdorn | Centering pin
-  **7** \varnothing 9 mm Zentrierdorn | Centering pin
-  **8** \varnothing 7 mm geteilter Zentrierdorn, auch als Verlängerung nutzbar | Split centering pin, also usable as extension
-  **9** \varnothing 7 mm Bohrer | Drill bit

2

Vorbereitung | Preparation

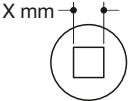
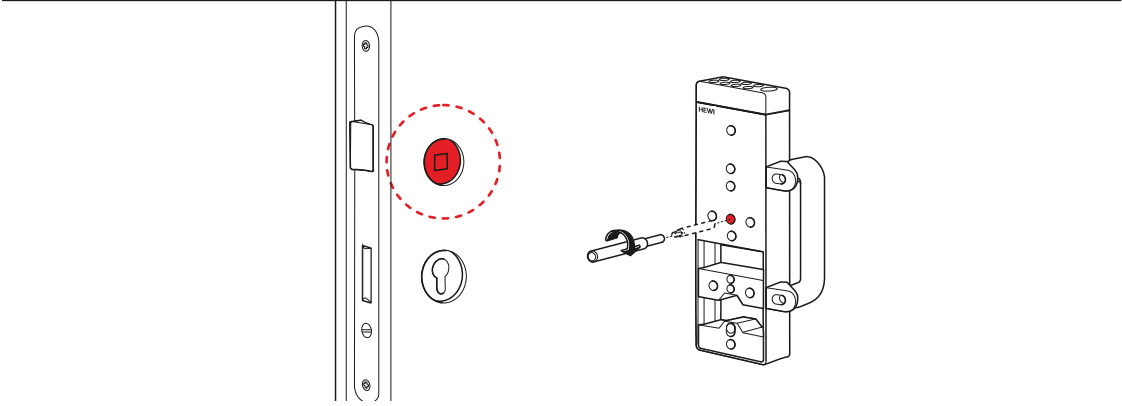

- ø 10 mm
- ø 9 mm
- ø 8,5 mm
- ø 8 mm
- ø 7 mm

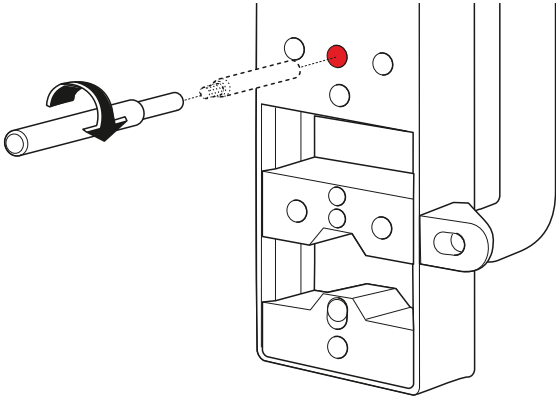

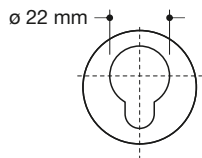
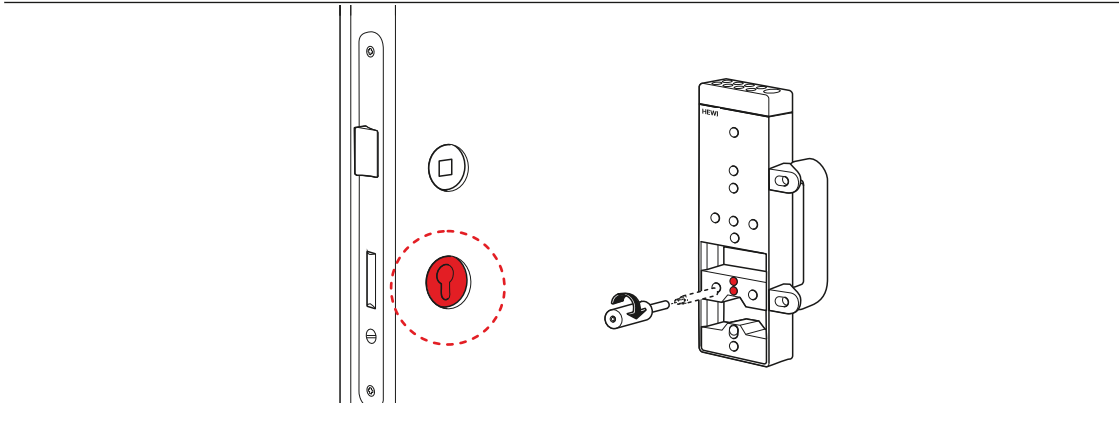

KABA
ø 22 mm

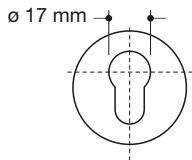

Profilzylinder (PZ)
Euro cylinder
ø 17 mm

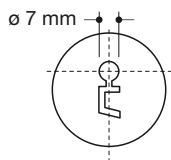

Buntbart (BB)
Lever key
ø 7 mm

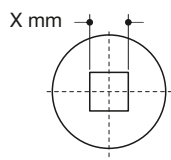
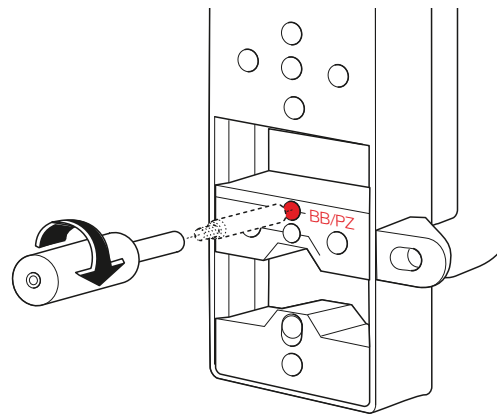

WC (NR/FB)
vacant/engaged
ø 8 mm
ø 7 mm
ø 6 mm
ø 5 mm

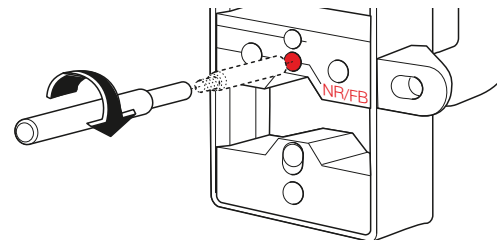

2

Montage | Mounting

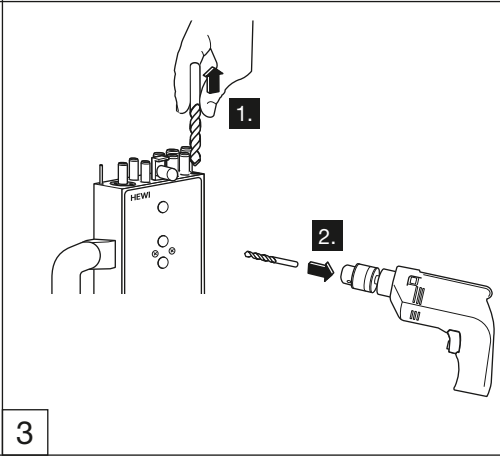
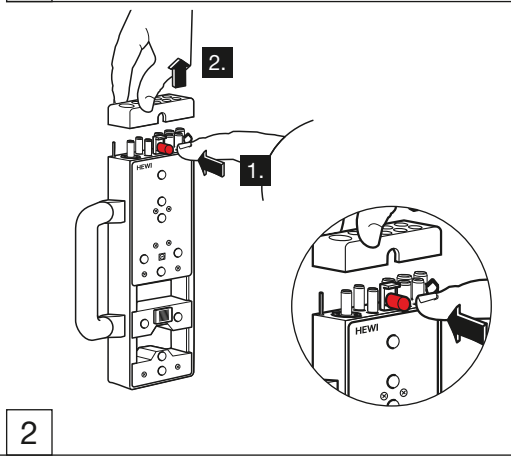
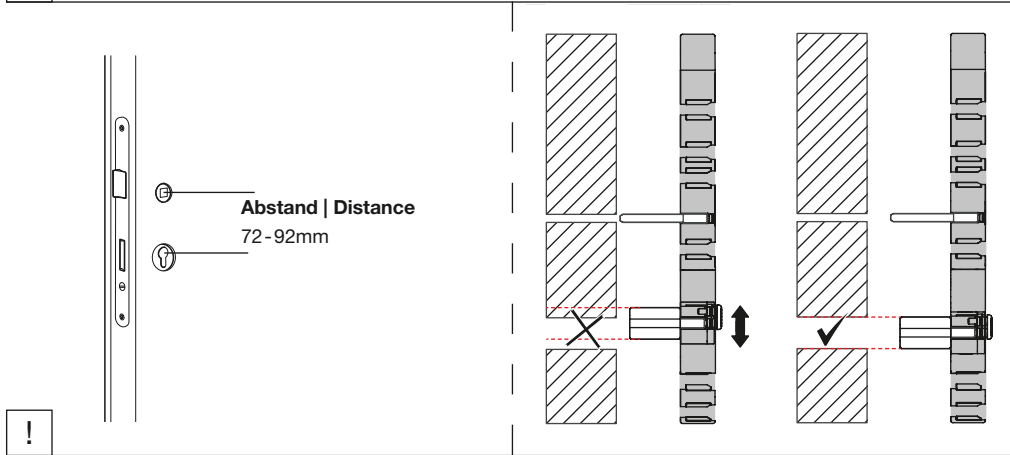
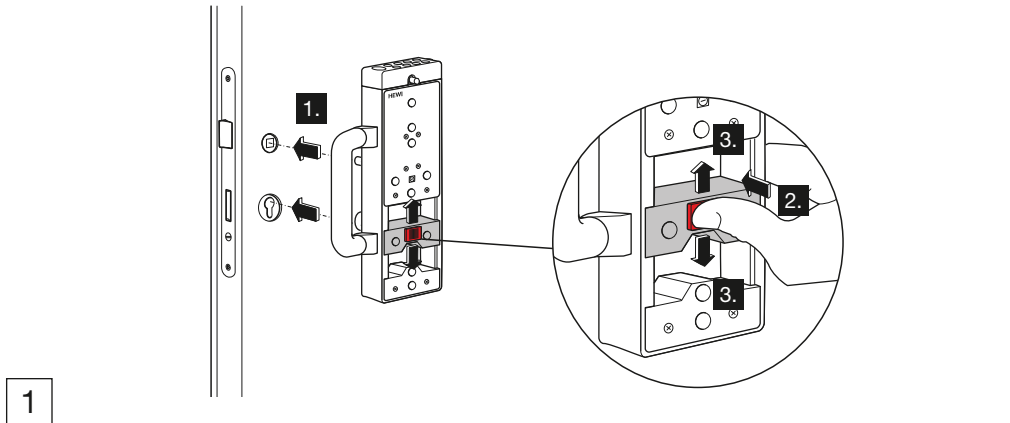



Achtung!
Nicht in oder durch den Schlosskasten bohren!
Auswahl Bohrbilder für Schilder und Rosetten siehe Seiten 8-9.

Very important to note!
Do not drill into or through the lockcase!
Drill pattern for backplate and roses see pages 8-9.

!

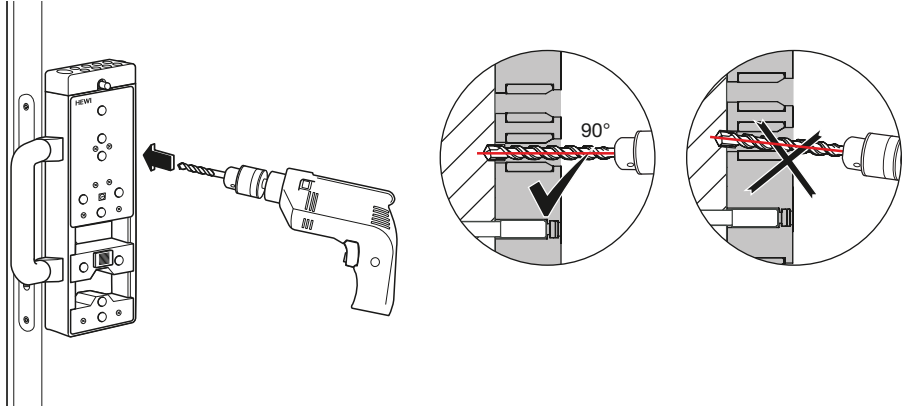

4

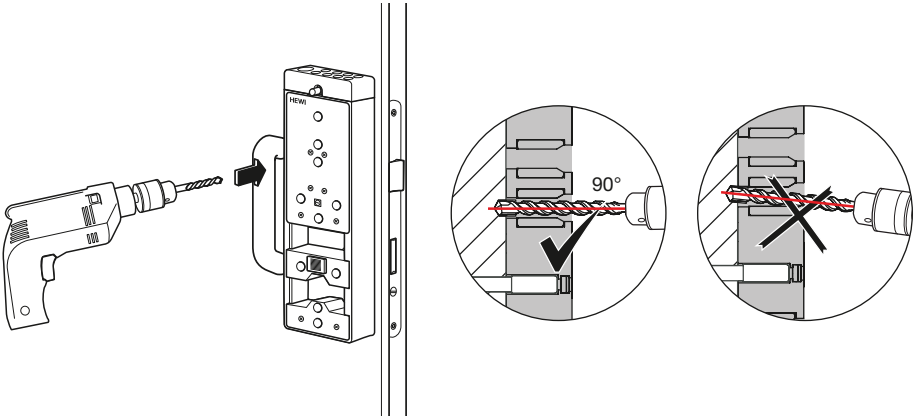

5

Auswahl Bohrbilder für Schilder und Rosetten | Drill pattern for backplate and roses

Rosette | Roses

305...
306...
307...
308...

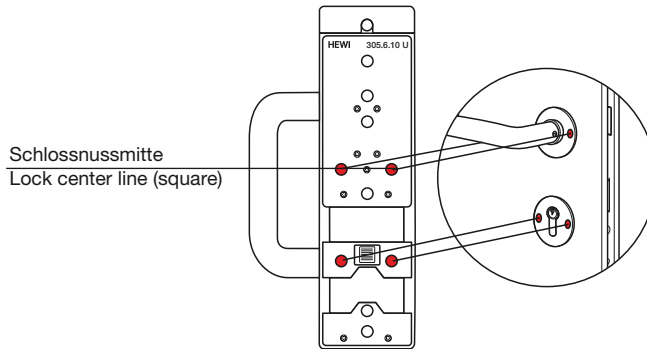

Schild | Backplate

217...R
230...R 230...H
285...R

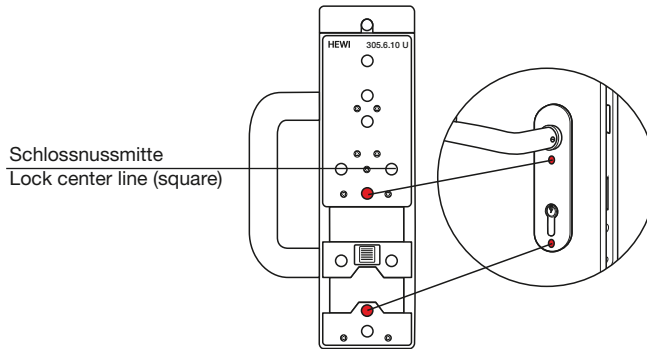

Schutzbeschlag (Kurzschild) | Security backplate (short)

...ES1

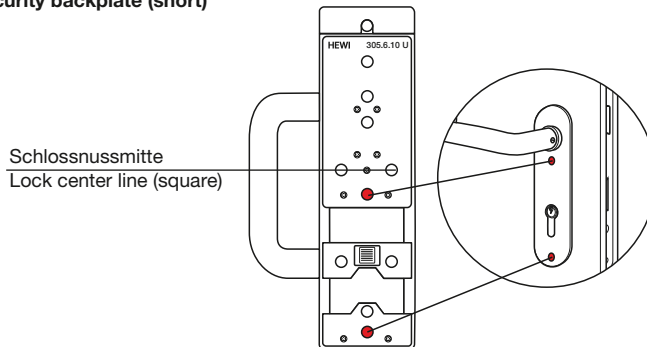

Auswahl Bohrbilder für Schilder und Rosetten | Drill pattern for backplate and roses

Schild | Backplate
230...E

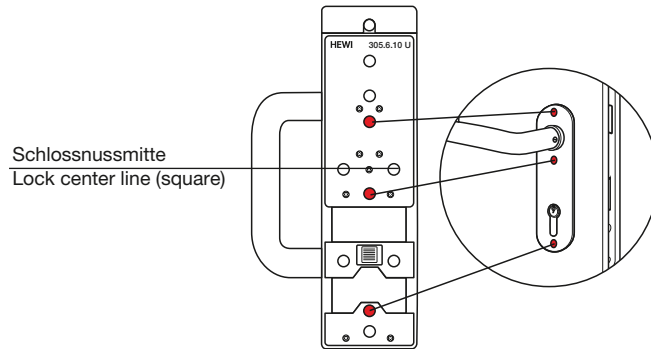

Schild | Backplate
235...R 219...H
220...H
235...H
236...H

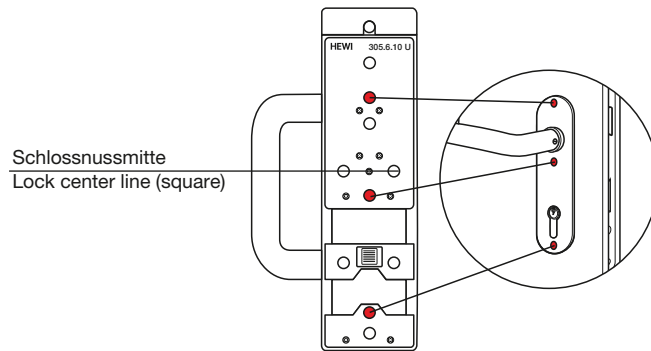

Schutzbeschlag (Langschild) | Security backplate (long)
...ES3

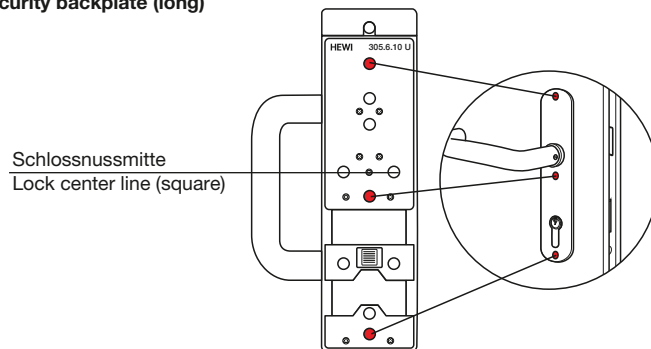



HEWI

www.hewi.com

Deutschland

HEWI Heinrich Wilke GmbH

Postfach 1260

D-34442 Bad Arolsen

Telefon: +49 5691 82-0

Telefax: +49 5691 82-319

info@hewi.de